

GLOBAL GARDEN PRODUCTS

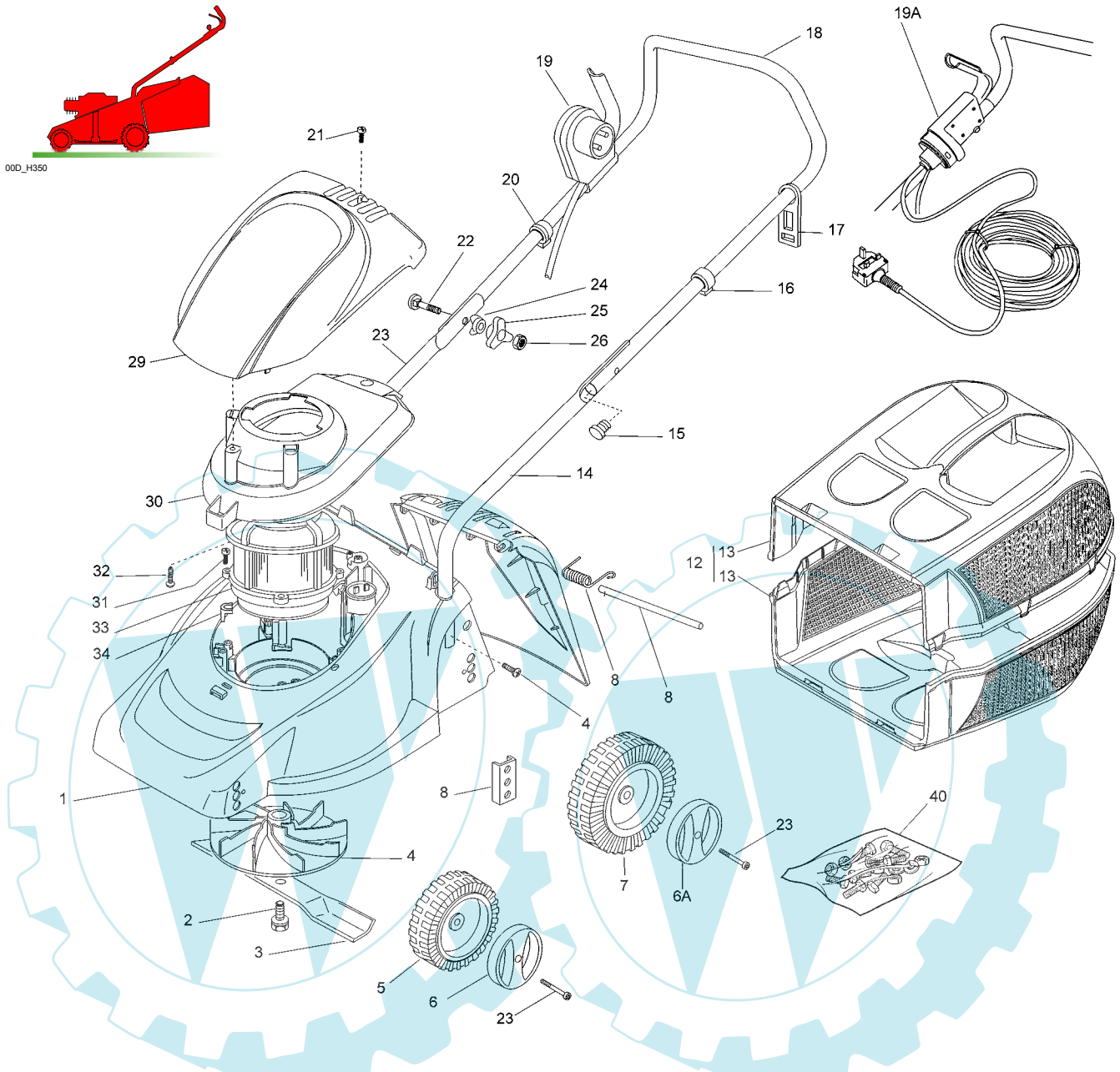

| Pos. | Code       | Q.ty | Descrizione       | Description     | Description        | Beschreibung    | Remarks |
|------|------------|------|-------------------|-----------------|--------------------|-----------------|---------|
| 1    | 81001917/0 | 1    | CHASSIS GIALLO    | DECK YELLOW     | CHÂSSIS JAUNE      | GEHÄUSE GELB    |         |
| -    | 81001905/0 | 1    | CHASSIS ROSSO     | DECK RED        | CHÂSSIS ROUGE      | GEHÄUSE ROT     |         |
| -    | 81001918/0 | 1    | CHASSIS VERDE     | DECK GREEN      | CHÂSSIS VERT       | GEHÄUSE GRÜN    |         |
| 2    | 81004352/0 | 1    | VITE              | SCREW           | VIS                | SCHRAUBE        |         |
| 3    | 81004115/1 | 1    | COLTELLO STANDARD | BLADE STANDARD  | LAME STANDARD      | MESSER STANDARD |         |
| 4    | 22465602/0 | 1    | MOZZO             | HUB             | MOYEU              | HALTER          |         |
| 5    | 22686083/0 | 2    | RUOTA Ø 130       | WHEEL Ø 130     | ROUE Ø 130         | RAD Ø 130       |         |
| 6    | 22110439/0 | 2    | COPRIMOZZO BIANCO | HUB CAP WHITE   | COUVRE-MOYEU BLANC | RADKAPPE WEIß   |         |
| -    | 22110436/0 | 2    | COPRIMOZZO GIALLO | HUB CAP YELLOW  | COUVRE-MOYEU JAUNE | RADKAPPE GELBE  |         |
| -    | 22110437/0 | 2    | COPRIMOZZO ROSSO  | HUB CAP RED     | COUVRE-MOYEU ROUGE | RADKAPPE ROTE   |         |
| 6A   | 22110448/0 | 2    | COPRIMOZZO BIANCO | HUB CAP WHITE   | COUVRE-MOYEU BLANC | RADKAPPE WEIß   |         |
| -    | 22110449/0 | 2    | COPRIMOZZO GIALLO | HUB CAP YELLOW  | COUVRE-MOYEU JAUNE | RADKAPPE GELBE  |         |
| -    | 22110450/0 | 2    | COPRIMOZZO ROSSO  | HUB CAP RED     | COUVRE-MOYEU ROUGE | RADKAPPE ROTE   |         |
| 7    | 22686085/0 | 2    | RUOTA Ø 160       | WHEEL Ø 160     | ROUE Ø 160         | RAD Ø 160       |         |
| 8    | 22785087/1 | 4    | SUPPORTO RUOTE    | SUPPORT, WHEELS | SUPPORT ROUE       | HALTER, RAD     |         |
| 9    | 12728450/0 | 2    | VITE              | SCREW           | VIS                | SCHRAUBE        |         |
| 10   | 22512530/0 | 1    | PERNO             | PIN             | PIVOT              | BOLZEN          |         |
| 11   | 22450250/0 | 1    | MOLLA             | SPRING          | RESSORT            | FEDER           |         |



## GLOBAL GARDEN PRODUCTS

| Pos. | Code       | Q.ty | Descrizione            | Description                 | Description                       | Beshreibung           | Remarks           |
|------|------------|------|------------------------|-----------------------------|-----------------------------------|-----------------------|-------------------|
| 12   | 97050000/0 | 1    | SACCO, COMPLETO        | GRASSCATCHER, COMPLETE      | SAC, COMPLETE                     | SACK, KOMPLETTE       |                   |
| 13   | 22486091/0 | 2    | SACCO, PARTE INF/SUP   | GRASS-BOX, UPPER/LOWER PART | SAC, PARTIE INFERIEURE/SUPERIEURE | KORB, OBER/UNTERTEIL  |                   |
| 14   | 81006608/0 | 1    | MANICO INFERIORE       | HANDLE, LOWER PART          | MANCHERON INFERIEURE              | HOLM, UNTERTEIL       |                   |
| 16   | 22192151/0 | 1    | FERMACAVO              | FAIRLEAD                    | FIXATION CABLE                    | KABELBEFESTIGUNG      |                   |
| 17   | 22195101/4 | 1    | FERMACAVO              | FAIRLEAD                    | FIXATION CABLE                    | KABELBEFESTIGUNG      |                   |
| 18   | 81006647/0 | 1    | MANICO SUPERIORE       | HANDLE, UPPER PART          | MANCHERON SUPERIEURE              | HOLM, OBERTEIL        |                   |
| 19   | -          | 1    | SALVAMOTORE            | DEAD HAND SWITCH            | INT. MAIN MORTE                   | TOT MANSCHALTER       | (SEE ENCLOSURE 1) |
| 19A  | -          | 1    | SALVAMOTORE            | DEAD HAND SWITCH            | INT. MAIN MORTE                   | TOT MANSCHALTER       | (SEE ENCLOSURE 1) |
| 20   | 22192010/0 | 1    | FASCETTA               | CLAMP                       | COLLIER                           | BOWDENZUGHALTER       |                   |
| 21   | 12728680/0 | 1    | VITE                   | SCREW                       | VIS                               | SCHRAUBE              |                   |
| 22   | 12815245/0 | 2    | VITE                   | SCREW                       | VIS                               | SCHRAUBE              |                   |
| 23   | 22524337/0 | 4    | PERNO                  | PIN                         | PIVOT                             | BOLZEN                |                   |
| 24   | 12523040/0 | 2    | ROSETTA                | WASHER                      | RONDELLE                          | SCHEIBE               |                   |
| 25   | 22399903/0 | 2    | MANOPOLINA             | KNOB                        | POIGNÉE                           | GRIFF                 |                   |
| 27   | 22600055/1 | 1    | PARASASSI              | STONE-GUARD                 | PARE-PIERRES                      | PRALLBLECH            |                   |
| 29   | 22055064/1 | 1    | CAPOTTINA              | COVER                       | CAPOT                             | HAUBE                 |                   |
| 30   | 22055050/2 | 1    | SUPPORTO CAPOTTINA     | SUPPORT, COVER              | SUPPORT CAPOT                     | HALTER, HAUBE         |                   |
| 31   | 12735410/0 | 4    | VITE                   | SCREW                       | VIS                               | SCHRAUBE              |                   |
| 32   | 12728450/0 | 1    | VITE                   | SCREW                       | VIS                               | SCHRAUBE              |                   |
| 33   | 18563645/0 | 1    | MOTORE FEVILL ELECTRIC | MOTOR FEVILL ELECTRIC       | MOTEUR FEVILL ELECTRIC            | MOTOR FEVILL ELECTRIC | 230-240V          |
| 34   | 22167700/0 | 4    | DISTANZIALE            | SPACER                      | ENTRETOISE                        | DISTANZRING           |                   |
| 40   | 81008668/0 | 1    | DOTAZIONE VITERIA      | OUTFIT, SCREWS              | DOTATION VISSERIE                 | SATZ, SCHRAUBEN       |                   |